

PD 160

MPD 160

| n_1 | i | n_2 | M_2 | kW_1 | HP_1 | RD |
|-------|-------|-------|-------|--------|--------|------|
| 2800 | 9.87 | 284 | 2700 | 83.5 | 113.6 | 0.96 |
| | 12.74 | 220 | 2880 | 69.0 | 93.9 | 0.96 |
| | 15.54 | 180 | 2880 | 56.6 | 77.0 | 0.96 |
| | 16.27 | 172 | 3150 | 59.1 | 80.4 | 0.96 |
| | 19.87 | 141 | 2610 | 40.1 | 54.6 | 0.96 |
| | 21.01 | 133 | 3150 | 45.8 | 62.3 | 0.96 |
| | 25.62 | 109 | 2880 | 34.3 | 46.7 | 0.96 |
| 32.75 | 85 | 2700 | 25.2 | 34.2 | 0.96 | |
| 1400 | 9.87 | 142 | 3000 | 46.4 | 63.1 | 0.96 |
| | 12.74 | 110 | 3200 | 38.4 | 52.2 | 0.96 |
| | 15.54 | 90 | 3200 | 31.4 | 42.8 | 0.96 |
| | 16.27 | 86 | 3500 | 32.8 | 44.7 | 0.96 |
| | 19.87 | 70 | 2900 | 22.3 | 30.3 | 0.96 |
| | 21.01 | 67 | 3500 | 25.4 | 34.6 | 0.96 |
| | 25.62 | 55 | 3200 | 19.1 | 25.9 | 0.96 |
| 32.75 | 43 | 3000 | 14.0 | 19.0 | 0.96 | |
| 900 | 9.87 | 91 | 3300 | 32.8 | 44.6 | 0.96 |
| | 12.74 | 71 | 3520 | 27.1 | 36.9 | 0.96 |
| | 15.54 | 58 | 3520 | 22.2 | 30.2 | 0.96 |
| | 16.27 | 55 | 3850 | 23.2 | 31.6 | 0.96 |
| | 19.87 | 45 | 3190 | 15.8 | 21.4 | 0.96 |
| | 21.01 | 43 | 3850 | 18.0 | 24.5 | 0.96 |
| | 25.62 | 35 | 3520 | 13.5 | 18.3 | 0.96 |
| 32.75 | 27 | 3300 | 9.9 | 13.5 | 0.96 | |

| n_1 | i | n_2 | M_2 | kW_1 | HP_1 | RD | sf | PAM |
|-------|-------|-------|-------|--------|--------|------|-----------------|-----------------|
| 2800 | 9.87 | 284 | 808 | 25 | 34 | 0.96 | 3.34 | 48/350 - 42/350 |
| | 12.74 | 220 | 1043 | 25 | 34 | 0.96 | 2.76 | 48/350 - 42/350 |
| | 15.54 | 180 | 1272 | 25 | 34 | 0.96 | 2.26 | 48/350 - 42/350 |
| | 16.27 | 172 | 1332 | 25 | 34 | 0.96 | 2.37 | 48/350 - 42/350 |
| | 19.87 | 141 | 1627 | 25 | 34 | 0.96 | 1.60 | 48/350 - 42/350 |
| | 21.01 | 133 | 1720 | 25 | 34 | 0.96 | 1.83 | 48/350 - 42/350 |
| | 25.62 | 109 | 2097 | 25 | 34 | 0.96 | 1.37 | 48/350 - 42/350 |
| 32.75 | 85 | 2681 | 25 | 34 | 0.96 | 1.01 | 48/350 - 42/350 | |
| 1400 | 9.87 | 142 | 1422 | 22 | 30 | 0.96 | 2.11 | 48/350 - 42/350 |
| | 12.74 | 110 | 1835 | 22 | 30 | 0.96 | 1.74 | 48/350 - 42/350 |
| | 15.54 | 90 | 2329 | 22 | 30 | 0.96 | 1.43 | 48/350 - 42/350 |
| | 16.27 | 86 | 2344 | 22 | 30 | 0.96 | 1.49 | 48/350 - 42/350 |
| | 19.87 | 70 | 2863 | 22 | 30 | 0.96 | 1.01 | 48/350 - 42/350 |
| | 21.01 | 87 | 3027 | 22 | 30 | 0.96 | 1.16 | 48/350 - 42/350 |
| | 25.62 | 55 | 3104 | 18.5 | 25 | 0.96 | 1.03 | 48/350 - 42/350 |
| 32.75 | 43 | 3217 | 15 | 20 | 0.96 | 0.93 | 48/350 - 42/350 | |
| 900 | 9.87 | 91 | 1508 | 15 | 20 | 0.96 | 2.19 | 48/350 - 42/350 |
| | 12.74 | 71 | 1947 | 15 | 20 | 0.96 | 1.81 | 48/350 - 42/350 |
| | 15.54 | 58 | 2375 | 15 | 20 | 0.96 | 1.48 | 48/350 - 42/350 |
| | 16.27 | 55 | 2486 | 15 | 20 | 0.96 | 1.55 | 48/350 - 42/350 |
| | 19.87 | 45 | 3036 | 15 | 20 | 0.96 | 1.05 | 48/350 - 42/350 |
| | 21.01 | 43 | 3210 | 15 | 20 | 0.96 | 1.20 | 48/350 - 42/350 |
| | 25.62 | 35 | 2871 | 11 | 15 | 0.96 | 1.23 | 48/350 - 42/350 |
| 32.75 | 27 | 2502 | 7.5 | 10 | 0.96 | 1.32 | 48/350 - 42/350 | |

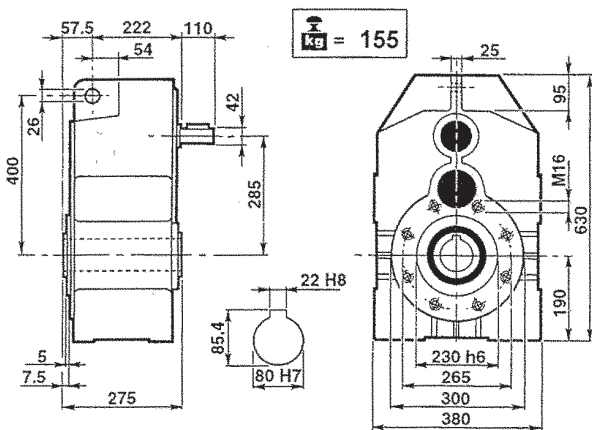

PD 160

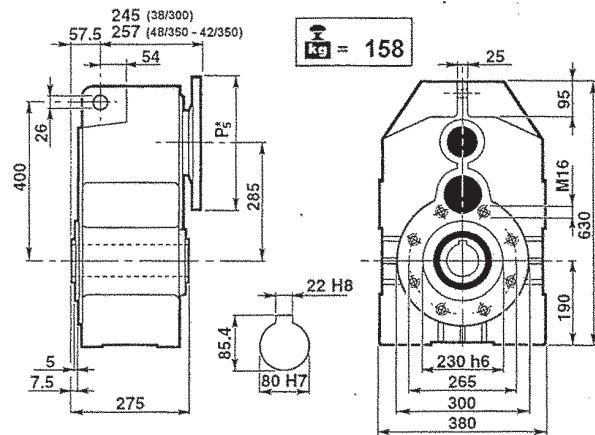

MPD 160

P_{5*} : Vedere i PAM per ogni singola versione
 P_{5*} : See PAM size for each single version
 P_{5*} : Siehe PAM Größe für jede Ausführung

P_{5*} : Voir les PAM pour chaque version simple
 P_{5*} : Consulte los PAM de cada versión por separado
 P_{5*} : Ver os PAM para cada versão

Carico radiale esterno ammissibile

Max. Allowable external radial load

Zulässige externe radiale Belastung

Charge radiale externe admissible

Carga radial externa admisible

Carga radial externa admissível

| Albero veloce / Input shaft / Eingangswelle / Arbre grande vitesse / Eje rápido / Eixo de entrada | | | | | | | |
|--|--------|-------|-------|----------|-------|-------|-------|
| 1400 min ⁻¹ | PD 160 | | | PD 160/3 | | | |
| | 3200 | | | 2300 | | | |
| Albero lento / Output shaft / Seitigtriebswelle / Arbre petite vitesse / Eje lento / Eixo de saída | | | | | | | |
| PD 160- PD 160/3 | | | | | | | |
| min ⁻¹ | 0° | 30° | 60° | 90° | 120° | 150° | 180° |
| 20 | 26910 | 27820 | 30190 | 33830 | 38010 | 41280 | 42570 |
| 40 | 20350 | 21270 | 23450 | 27090 | 31280 | 34729 | 36015 |
| 60 | 17280 | 18005 | 20190 | 23825 | 28010 | 31460 | 32915 |
| 80 | 15095 | 15825 | 18005 | 21645 | 25830 | 29465 | 30735 |
| 100 | 13640 | 14370 | 16365 | 19990 | 24180 | 27770 | 29280 |
| 120 | 12545 | 13095 | 15275 | 18735 | 23100 | 26735 | 28190 |
| 140 | 11640 | 12150 | 14173 | 17383 | 21434 | 24806 | 26156 |
| 160 | 10910 | 11388 | 13284 | 16293 | 20089 | 23251 | 24516 |

Rotazione oraria
 Clockwise rotation
 Uhrzeigersinn
 Rotation dans le sens des aiguilles d'une montre
 Rotación en sentido horario
 Rotação horária

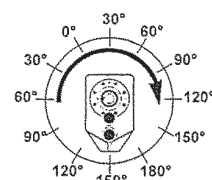

Rotazione antioraria
 Anticlockwise rotation
 Gegenurzeigersinn
 Rotation dans le sens contraire des aiguilles d'une montre
 Rotación en sentido antihorario
 Rotação anti-horária

