

DATI TECNICI / TECHNICAL DATA / TECHNISCHE DATEN  
 CARACTÉRISTIQUES TECHNIQUES / DATOS TÉCNICOS / CARACTERÍSTICAS TÉCNICAS

CV RCV	i	n <sub>1</sub> = 2800 min <sup>-1</sup>			n <sub>1</sub> = 1400 min <sup>-1</sup>			n <sub>1</sub> = 900 min <sup>-1</sup>					
		n <sub>2</sub>	Mn <sub>2</sub>	P <sub>1</sub>	n <sub>2</sub>	Mn <sub>2</sub>	P <sub>1</sub>	n <sub>2</sub>	Mn <sub>2</sub>	P <sub>1</sub>	IEC B5	IEC B14	NEMA
		min <sup>-1</sup>	Nm	kW	min <sup>-1</sup>	Nm	kW	min <sup>-1</sup>	Nm	kW			
552	2.78	1007	459	50	504	550	30.2	324	550	19.4	90-100-112-132-160-180	132	180-210-250-280
	3.17	883	467	45	442	560	27.0	284	560	17.3	90-100-112-132-160-180	132	180-210-250-280
	3.68	761	508	42	380	608	25.2	245	608	16.2	90-100-112-132-160-180	132	180-210-250-280
	4.16	673	550	40	337	660	24.2	216	660	15.6	90-100-112-132-160-180	132	180-210-250-280
	4.57	613	611	41	306	732	24	197	732	15.7	90-100-112-132-160-180	132	180-210-250-280
	5.50	509	660	37	255	790	22	164	790	14.1	90-100-112-132-160-180	132	180-210-250-280
	6.03	464	673	34	232	805	20	149	805	13.1	90-100-112-132-160-180	132	180-210-250-280
	7.39	379	728	30	189	872	18	122	872	11.6	90-100-112-132-160-180	132	180-210-250-280
	8.39	334	766	28	167	917	16.7	107	917	10.7	90-100-112-132-160-180	132	180-210-250
	9.49	295	786	25	148	941	15.1	95	942	9.7	90-100-112-132-160-180	132	180-210-250
	11.00	255	892	25	127	1070	14.9	82	1070	9.5	90-100-112-132-160-180	132	180-210-250
	12.07	232	837	21	116	1002	12.7	75	1002	8.2	90-100-112-132-160-180	132	180-210-250
	14.19	197	959	21	99	1150	12.4	63	1150	8.0	90-100-112-132-160-180	132	180-210-250
	15.56	180	901	17.7	90	1080	10.6	58	1080	6.8	90-100-112-132-160-180	132	180-210-250
	19.06	147	960	15.4	73	1149	9.2	47.2	1150	5.9	90-100-112-132-160-180	132	180-210-250
	22.74	123	984	13.2	62	1180	7.9	39.6	1180	5.1	90-100-112-132-160	132	180-210
	24.94	112	999	12.2	56	1197	7.3	36.1	1197	4.7	90-100-112-132-160	132	180-210
	30.55	92	1009	10.1	45.8	1208	6	29.5	1208	3.9	90-100-112-132-160	132	180-210
	35.01	80	1003	8.7	40.0	1203	5.2	25.7	1203	3.4	90-100-112-132-160	132	180-210
	38.40	73	998	7.9	36.5	1195	4.8	23.4	1197	3.1	90-100-112-132-160	132	180-210
47.03	60	942	6.2	29.8	1128	3.7	19.1	1129	2.4	90-100-112-132-160	132	180-210	
53.46	52	839	4.8	26.2	1005	2.9	16.8	1003	1.8	90-100-112	—	180-210	
65.48	42.8	779	3.6	21.4	934	2.2	13.7	931	1.4	90-100-112	—	180-210	
553	70.22	39.9	926	4.2	19.9	1110	2.5	12.8	1112	1.6	80-90-100-112-132	132	140-180-210
	88.88	31.5	986	3.5	15.8	1180	2.1	10.1	1180	1.3	80-90-100-112-132	132	140-180-210
	108.86	25.7	919	2.7	12.9	1101	1.6	8.3	1103	1.0	80-90-100-112-132	132	140-180-210
	118.46	23.6	1000	2.7	11.8	1198	1.6	7.6	1200	1.0	80-90-100-112-132	132	140-180-210
	125.58	42.8	927	4.5	11.1	1112	1.4	7.2	1112	0.90	80-90-100-112-132	132	140-180-210
	145.09	19.3	917	2.0	9.7	1101	1.2	6.2	1099	0.77	80-90-100-112-132	132	140-180-210
	170.18	42.8	987	4.8	8.2	1184	1.1	5.3	1184	0.71	80-90-100-112-132	132	140-180-210
	183.64	15.2	969	1.7	7.6	1161	1	4.9	1156	0.64	80-90-100-112-132	132	140-180-210
	224.93	12.4	953	1.3	6.2	1138	0.8	4	1139	0.51	80-90-100-112-132	132	140-180-210
	259.37	10.8	959	1.2	5.4	1148	0.7	3.5	1148	0.45	80-90-100-112	—	140-180-210
317.70	8.8	1004	1.0	4.4	1205	0.6	2.8	1203	0.38	80-90-100-112	—	140-180-210	

DIMENSIONI / DIMENSIONS / ABMESSUNGEN / DIMENSIONS / DIMENSIONES / DIMENSÕES

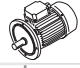
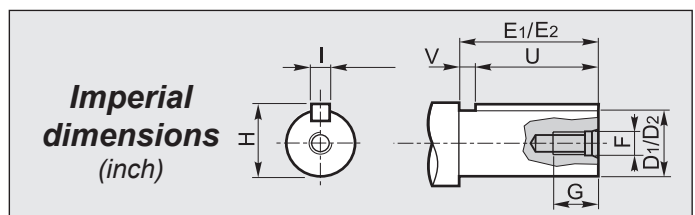
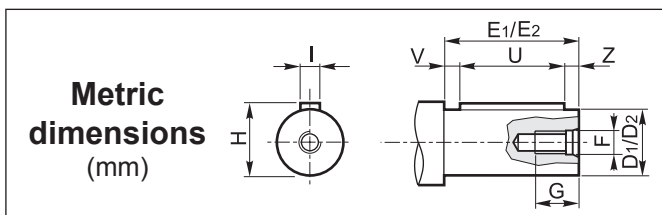

1 **Albero entrata / Input shaft / Antriebswelle**  
**Arbre d'entrée / Eje de entrada / Eixo de entrada**

CV RCV	D <sub>1</sub> h6	E <sub>1</sub>	F	G	H	I	U	V	Z
552	38	80	M12	25	41	10	70	5	5
553	28	60	M10	20	31	8	50	5	5

1 **Albero entrata / Input shaft / Antriebswelle**  
**Arbre d'entrée / Eje de entrada / Eixo de entrada**

CV RCV	D <sub>1</sub>	E <sub>1</sub>	F	G	H	I	U	V
552	1.500	3.150	3/8-16	0.906	1.664	0.375	2.750	0.400
553	1.125	2.362	5/16-18	0.709	1.236	0.250	1.750	0.612

2 **Albero uscita / Output shaft / Abtriebswelle**  
**Arbre de sortie / Eje de salida / Eixo de saída**

CV RCV	D <sub>2</sub> h6	E <sub>2</sub>	F	G	H	I	U	V	Z
552 553	40	80	M12	33	43	12	70	5	5
	45	90	M12	33	48.5	14	70	10	10
	48	100	M12	33	51.5	14	90	5	5
	50	100	M16	45	53.5	14	90	5	5
	55	110	M16	45	59	16	90	10	10
	60	120	M20	50	64	18	100	10	10

2 **Albero uscita / Output shaft / Abtriebswelle**  
**Arbre de sortie / Eje de salida / Eixo de saída**

CV RCV	D <sub>2</sub>	E <sub>2</sub>	F	G	H	I	U	V
552 553	2.187	4.330	5/8-11	1.772	2.409	0.500	3.250	1.081

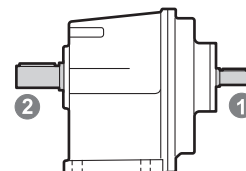

A richiesta / On request / Auf Anfrage / Sur demande / Bajo demanda / Sob consulta