

DATI TECNICI / TECHNICAL DATA / TECHNISCHE DATEN  
 CARACTÉRISTIQUES TECHNIQUES / DATOS TÉCNICOS / CARACTERÍSTICAS TÉCNICAS

CV RCV	i	n <sub>1</sub> = 2800 min <sup>-1</sup>			n <sub>1</sub> = 1400 min <sup>-1</sup>			n <sub>1</sub> = 900 min <sup>-1</sup>					
		n <sub>2</sub> min <sup>-1</sup>	Mn <sub>2</sub> Nm	P <sub>1</sub> kW	n <sub>2</sub> min <sup>-1</sup>	Mn <sub>2</sub> Nm	P <sub>1</sub> kW	n <sub>2</sub> min <sup>-1</sup>	Mn <sub>2</sub> Nm	P <sub>1</sub> kW	IEC B5	IEC B14	NEMA
302	3.74	749	203	16.6	374	243	9.9	241	243	6.4	71-80-90-100/112-132	100-112-132	140-180
	4.56	614	215	14.4	307	258	8.6	197	258	5.6	71-80-90-100/112-132	100-112-132	140-180
	5.11	548	210	12.6	274	251	7.5	176	252	4.8	71-80-90-100/112-132	100-112-132	140-180
	6.22	450	211	10.4	225	253	6.2	145	253	4.0	71-80-90-100/112-132	100-112-132	140-180
	6.93	404	211	9.3	202	252	5.6	130	252	3.6	71-80-90-100/112-132	100-112-132	140-180
	7.51	373	206	8.4	186	246	5.0	120	246	3.2	71-80-90-100/112-132	100-112-132	140-180
	7.78	360	218	8.6	180	261	5.1	116	261	3.3	71-80-90-100/112-132	100-112-132	140-180
	9.14	306	241	8.1	153	288	4.8	98	289	3.1	71-80-90-100/112-132	100-112-132	140-180
	10.18	275	247	7.4	138	296	4.4	88	297	2.9	71-80-90-100/112-132	100-112-132	140-180
	11.43	245	254	6.8	122	305	4.1	79	304	2.6	71-80-90-100/112-132	100-112-132	140-180
	12.62	222	233	5.6	111	279	3.4	71	279	2.2	71-80-90-100/112	100-112	140-180
	15.37	182	246	4.9	91	295	2.9	59	295	1.9	71-80-90-100/112	100-112	140-180
	17.11	164	253	4.5	82	303	2.7	53	302	1.7	71-80-90-100/112	100-112	140-180
	19.21	146	259	4.1	73	310	2.5	46.9	310	1.6	71-80-90-100/112	100-112	140-180
	24.19	116	239	3.0	58	285	1.8	37.2	285	1.2	71-80-90-100/112	100-112	140-180
29.45	95	251	2.6	47.5	300	1.6	30.6	300	1.0	71-80-90-100/112	100-112	140-180	
32.80	85	257	2.4	42.7	308	1.4	27.4	308	0.92	71-80-90-100/112	100-112	140-180	
36.82	76	263	2.2	38.0	315	1.3	24.4	316	0.84	71-80-90-100/112	100-112	140-180	
303	41.20	68	258	2.0	34.0	310	1.2	21.8	308	0.76	63-71-80-90	90	56-140
	46.20	61	264	1.8	30.3	316	1.1	19.5	316	0.69	63-71-80-90	90	56-140
	54.00	52	242	1.4	25.9	290	0.85	16.7	290	0.54	63-71-80-90	90	56-140
	65.80	42.6	253	1.2	21.3	304	0.73	13.7	304	0.47	63-71-80-90	90	56-140
	73.60	38.2	260	1.1	19.1	310	0.67	12.3	310	0.43	63-71-80-90	90	56-140
	82.20	34.1	265	1.0	17.0	317	0.61	10.9	318	0.39	63-71-80-90	90	56-140
	99.30	28.2	243	0.77	14.1	292	0.46	9.1	291	0.30	63-71-80-90	90	56-140
	120.90	23.2	256	0.67	11.6	306	0.40	7.4	306	0.26	63-71-80-90	90	56-140
	134.70	20.8	261	0.61	10.4	314	0.37	6.7	313	0.24	63-71-80-90	90	56-140
	151.10	18.5	268	0.56	9.3	320	0.33	6.0	320	0.21	63-71-80-90	90	56-140
	189.20	14.8	249	0.42	7.4	299	0.25	4.8	298	0.16	63-71-80-90	90	56-140
	230.30	12.2	267	0.37	6.1	320	0.22	3.9	319	0.14	63-71-80-90	90	56-140
	256.50	10.9	279	0.34	5.5	334	0.21	3.5	335	0.13	63-71-80-90	90	56-140
	287.90	9.7	288	0.32	4.9	346	0.19	3.1	345	0.12	63-71-80-90	90	56-140

DIMENSIONI / DIMENSIONS / ABMESSUNGEN / DIMENSIONS / DIMENSIONES / DIMENSÕES

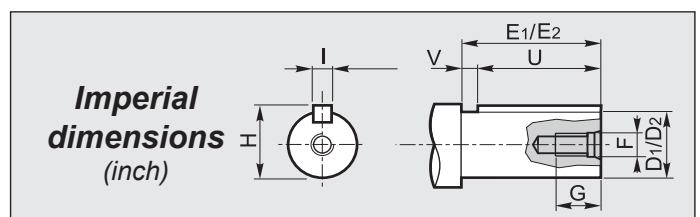
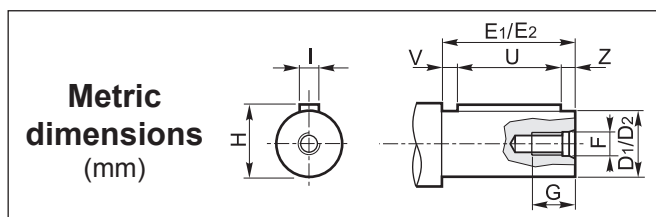

① **Albero entrata / Input shaft / Antriebswelle**  
 Arbre d'entrée / Eje de entrada / Eixo de entrada

CV	D <sub>1</sub> h6	E <sub>1</sub>	F	G	H	I	U	V	Z
302	24	50	M8	18	27	8	40	5	5
303	19	40	M6	15	21.5	6	30	5	5

① **Albero entrata / Input shaft / Antriebswelle**  
 Arbre d'entrée / Eje de entrada / Eixo de entrada

CV	D <sub>1</sub>	E <sub>1</sub>	F	G	H	I	U	V
302	1.000	1.969	5/16-18	0.709	1.109	0.250	1.500	0.469
303	0.750	1.575	5/16-18	0.709	0.832	0.187	1.000	0.575

② **Albero uscita / Output shaft / Abtriebswelle**  
 Arbre de sortie / Eje de salida / Eixo de saída

CV RCV	D <sub>2</sub> h6	E <sub>2</sub>	F	G	H	I	U	V	Z
302 303	25	50	M8	18	28	8	40	5	5
	28	60	M8	18	31	8	50	5	5
	30	60	M10	22	33	8	50	5	5
	32	80	M10	22	35	10	70	5	5
	35	80	M10	22	38	10	70	5	5
	38	80	M10	22	41	10	70	5	5
40	80	M12	28	43	12	70	5	5	

② **Albero uscita / Output shaft / Abtriebswelle**  
 Arbre de sortie / Eje de salida / Eixo de saída

CV RCV	D <sub>2</sub>	E <sub>2</sub>	F	G	H	I	U	V
302 303	1.187	2.362	3/8-16	0.906	1.299	0.250	1.750	0.612

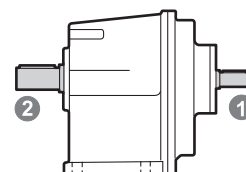

A richiesta / On request / Auf Anfrage / Sur demande / Bajo demanda / Sob consulta