

DATI TECNICI / TECHNICAL DATA / TECHNISCHE DATEN
 CARACTÉRISTIQUES TECHNIQUES / DATOS TÉCNICOS / CARACTERÍSTICAS TÉCNICAS

CV RCV	i	n ₁ = 2800 min ⁻¹			n ₁ = 1400 min ⁻¹			n ₁ = 900 min ⁻¹					
		n ₂ min ⁻¹	Mn ₂ Nm	P ₁ kW	n ₂ min ⁻¹	Mn ₂ Nm	P ₁ kW	n ₂ min ⁻¹	Mn ₂ Nm	P ₁ kW	IEC B5	IEC B14	NEMA
352	3.74	749	262	21	374	314	12.8	241	313	8.2	71-80-90-100-112-132	100-112-132	140-180
	4.56	614	277	18.6	307	332	11.1	197	332	7.1	71-80-90-100-112-132	100-112-132	140-180
	5.11	548	289	17.3	274	346	10.3	176	345	6.6	71-80-90-100-112-132	100-112-132	140-180
	6.22	450	304	14.9	225	364	8.9	145	364	5.7	71-80-90-100-112-132	100-112-132	140-180
	6.93	404	312	13.8	202	374	8.2	130	374	5.3	71-80-90-100-112-132	100-112-132	140-180
	7.51	373	294	12.0	186	352	7.2	120	352	4.6	71-80-90-100-112-132	100-112-132	140-180
	7.78	360	321	12.6	180	384	7.5	116	384	4.8	71-80-90-100-112-132	100-112-132	140-180
	9.14	306	310	10.4	153	370	6.2	98	371	4.0	71-80-90-100-112-132	100-112-132	140-180
	10.18	275	318	9.5	138	381	5.7	88	381	3.7	71-80-90-100-112-132	100-112-132	140-180
	11.43	245	326	8.7	122	391	5.2	79	391	3.4	71-80-90-100-112-132	100-112-132	140-180
	12.62	222	300	7.3	111	360	4.4	71	360	2.8	71-80-90-100-112	100-112	140-180
	15.37	182	316	6.3	91	379	3.8	59	378	2.4	71-80-90-100-112	100-112	140-180
	17.11	164	324	5.8	82	388	3.5	53	388	2.2	71-80-90-100-112	100-112	140-180
	19.21	146	333	5.3	73	399	3.2	46.9	399	2.0	71-80-90-100-112	100-112	140-180
24.19	116	308	3.9	58	369	2.3	37.2	368	1.5	71-80-90-100-112	100-112	140-180	
29.45	95	325	3.4	47.5	390	2.0	30.6	389	1.3	71-80-90-100-112	100-112	140-180	
32.80	85	330	3.1	42.7	396	1.8	27.4	397	1.2	71-80-90-100-112	100-112	140-180	
36.82	76	338	2.8	38.0	403	1.7	24.4	405	1.1	71-80-90-100-112	100-112	140-180	
353	41.20	68	332	2.5	34.0	396	1.5	21.8	397	0.98	63-71-80-90	90	56-140
	46.20	61	339	2.3	30.3	406	1.4	19.5	405	0.89	63-71-80-90	90	56-140
	54.00	52	311	1.8	25.9	372	1.1	16.7	372	0.70	63-71-80-90	90	56-140
	65.80	42.6	326	1.6	21.3	391	0.94	13.7	391	0.60	63-71-80-90	90	56-140
	73.60	38.2	333	1.4	19.1	398	0.86	12.3	400	0.55	63-71-80-90	90	56-140
	82.20	34.1	341	1.3	17.0	408	0.78	10.9	408	0.50	63-71-80-90	90	56-140
	99.30	28.2	314	1.0	14.1	377	0.60	9.1	375	0.38	63-71-80-90	90	56-140
	120.90	23.2	329	0.86	11.6	393	0.51	7.4	392	0.33	63-71-80-90	90	56-140
	134.70	20.8	336	0.79	10.4	400	0.47	6.7	401	0.30	63-71-80-90	90	56-140
	151.10	18.5	344	0.72	9.3	411	0.43	6.0	410	0.28	63-71-80-90	90	56-140
	189.20	14.8	317	0.53	7.4	383	0.32	4.8	381	0.20	63-71-80-90	90	56-140
	230.30	12.2	342	0.47	6.1	408	0.28	3.9	408	0.18	63-71-80-90	90	56-140
	256.50	10.9	357	0.44	5.5	428	0.26	3.5	429	0.17	63-71-80-90	90	56-140
	287.90	9.7	369	0.40	4.9	440	0.24	3.1	442	0.16	63-71-80-90	90	56-140

DIMENSIONI / DIMENSIONS / ABMESSUNGEN / DIMENSIONS / DIMENSIONES / DIMENSÕES

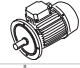
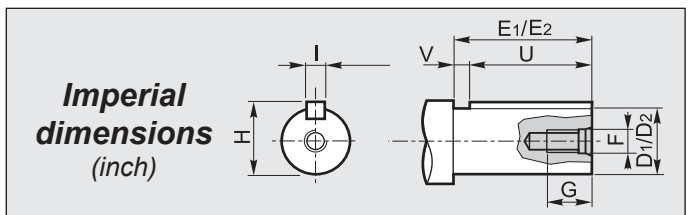
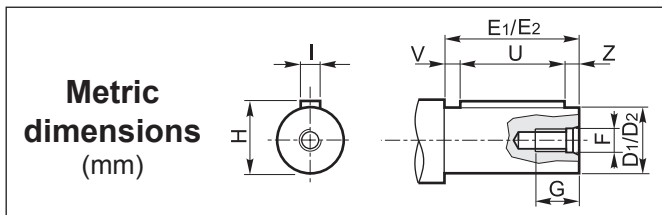

1 Albero entrata / Input shaft / Antriebswelle
 Arbre d'entrée / Eje de entrada / Eixo de entrada

CV RCV	D ₁ h6	E ₁	F	G	H	I	U	V	Z
352	24	50	M8	18	27	8	40	5	5
353	19	40	M6	15	21.5	6	30	5	5

1 Albero entrata / Input shaft / Antriebswelle
 Arbre d'entrée / Eje de entrada / Eixo de entrada

CV	D ₁	E ₁	F	G	H	I	U	V
352	1.000	1.969	5/16-18	0.709	1.109	0.250	1.500	0.469
353	0.750	1.575	5/16-18	0.709	0.832	0.187	1.000	0.575

2 Albero uscita / Output shaft / Abtriebswelle
 Arbre de sortie / Eje de salida / Eixo de saída

CV RCV	D ₂ h6	E ₂	F	G	H	I	U	V	Z
352	28	60	M8	18	31	8	50	5	5
	30	60	M10	22	33	8	50	5	5
353	32	80	M10	22	35	10	70	5	5
	35	80	M10	22	38	10	70	5	5
	38	80	M10	22	41	10	70	5	5
	40	80	M12	28	43	12	70	5	5

2 Albero uscita / Output shaft / Abtriebswelle
 Arbre de sortie / Eje de salida / Eixo de saída

CV RCV	D ₂	E ₂	F	G	H	I	U	V
352	1.375	3.150	3/8-16	0.906	1.513	0.312	2.500	0.650
353								

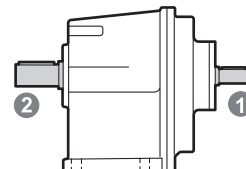

A richiesta / On request / Auf Anfrage / Sur demande / Bajo demanda / Sob consulta