

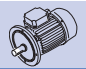

Dati tecnici riduttori/ Reducer technical data / Technische Daten Getriebe

Caractéristiques techniques reducteurs/ Datos técnicos reductores / Características técnicas ridutor

21

| RFV | i | $n_1 = 2800 \text{ min}^{-1}$ | | | $n_1 = 1400 \text{ min}^{-1}$ | | | $n_1 = 900 \text{ min}^{-1}$ | | |  IEC B5 IEC B14 | |
|------------|-----------|-------------------------------|--------------|-------------|-------------------------------|--------------|-------------|------------------------------|--------------|---------------------|---|-------------------------|
| | | n_2 min ⁻¹ | Mn_2 Nm | P_1 kW | n_2 min ⁻¹ | Mn_2 Nm | P_1 kW | n_2 min ⁻¹ | Mn_2 Nm | P_1 kW | | |
| 402 | 4.83 | 580 | 380 | 24.27 | 290 | 454 | 14.51 | 186 | 454 | 9.33 | 132 112 100 90 80 71 | 132 112 100 90 |
| | 5.58 | 502 | 423 | 23.38 | 251 | 507 | 14.01 | 161 | 507 | 9.01 | | |
| | 6.60 | 424 | 475 | 22.17 | 212 | 570 | 13.31 | 136 | 570 | 8.56 | | |
| | 7.63 | 367 | 516 | 20.86 | 183 | 619 | 12.51 | 118 | 619 | 8.04 | | |
| | 8.96 | 313 | 581 | 20.02 | 156 | 697 | 12.01 | 100 | 697 | 7.72 | | |
| | 10.72 | 261 | 638 | 18.37 | 131 | 765 | 11.01 | 84 | 765 | 7.08 | | |
| | 12.17 | 230 | 648 | 16.45 | 115 | 781 | 9.91 | 74 | 781 | 6.37 | | |
| | 14.06 | 199 | 722 | 15.85 | 100 | 866 | 9.51 | 64 | 866 | 6.11 | | |
| | 16.50 | 170 | 812 | 15.19 | 85 | 974 | 9.11 | 55 | 974 | 5.85 | | |
| | 19.75 | 142 | 864 | 13.50 | 71 | 1037 | 8.11 | 46 | 1037 | 5.21 | | |
| | 22.60 | 124 | 867 | 11.84 | 62 | 1040 | 7.10 | 40 | 1040 | 4.57 | | |
| | 26.12 | 107 | 918 | 10.85 | 54 | 1101 | 6.50 | 34 | 1101 | 4.18 | | |
| | 30.64 | 91 | 1000 | 10.07 | 46 | 1200 | 6.04 | 29 | 1200 | 3.89 | | |
| | 34.52 | 81 | 1000 | 8.94 | 41 | 1200 | 5.37 | 26 | 1200 | 3.45 | | |
| | 40.50 | 69 | 1000 | 7.62 | 35 | 1200 | 4.57 | 22 | 1200 | 2.94 | | |
| | 48.48 | 58 | 1043 | 6.64 | 29 | 1200 | 3.82 | 19 | 1200 | 2.46 | | |
| | 57.20 | 49 | 1091 | 5.89 | 24 | 1200 | 3.24 | 16 | 1200 | 2.08 | | |
| 68.47 | 41 | 1143 | 5.15 | 20 | 1200 | 2.70 | 13 | 1200 | 1.74 | 112-100 90-80-71 | 112-110 90 | |

RFV 402 H...IEC

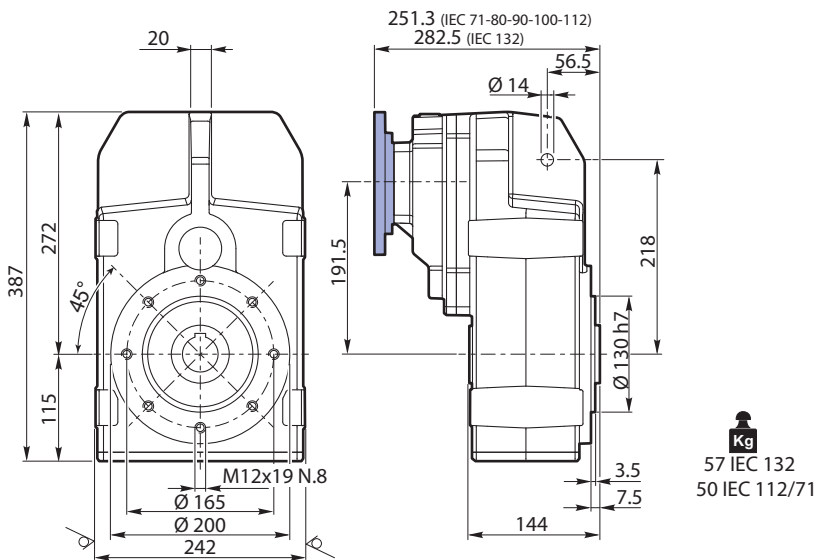

RFV 402 H...FV

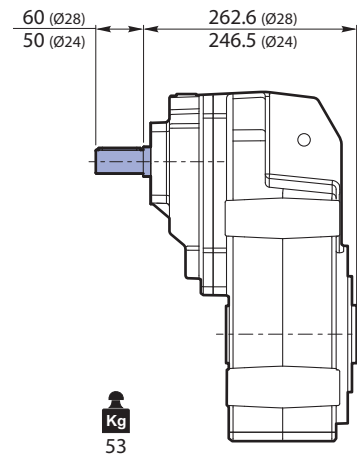

Albero entrata / Input shaft / Antriebswelle

Arbre d'entrée / Eje de entrada / Eixo de entrada

Albero uscita / Output shaft / Abtriebswelle

Arbre de sortie / Eje de salida / Eixo de saída

H40 STANDARD

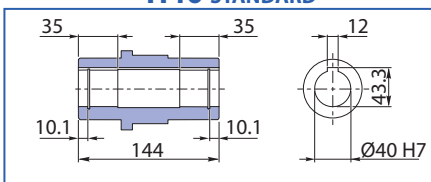

H45

